

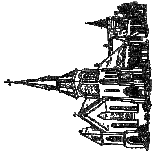

ST. JOHN'S EPISCOPAL CHURCH
 123 N. Michigan Ave.
 Saginaw, MI 48602



HEAR WHAT THEY'RE SAYING...

"This Church, from it's very beginning has been supportive of the generations to come. This transition is a calling from God to be loving and welcoming to everyone."

~ **Mary Spence**, *Parishioner*

"As a mom with young ones, there are many times we have to exit the service gracefully and quietly. This is a barrier right now as we have to walk right past the pulpit during the sermon. ... The new plans really help address this."

~ **Natasha Coulouris**, *Parishioner*

"We have a number of parishioners who are not coming to church because of our accessibility issue. It's critical ... making our church truly open and available to everybody."

~ **Michael Keenan**, *Parishioner*

"Our ushers have commented that the number one question they hear is "Where is the bathroom?" ...and then they have to attempt to give directions! Our bathrooms are not accessible. It becomes a matter of comfort, convenience, and dignity."

~ **Ellen Redfield**, *Former Senior Warden*

**ST. JOHN'S EPISCOPAL CHURCH
 ACCESSIBILITY CAMPAIGN**

*Welcoming everyone to join us as we...
 Care, Share, Worship, Celebrate, and Love.*



ST. JOHN'S ACCESSIBILITY CAMPAIGN COMMITMENT:

With a grateful heart for God's boundless generosity, and as an expression of my Christian stewardship, I make this commitment to the St. John's Accessibility Campaign because of the importance of making St. John's a more welcoming place for all.

Contact Information:

Mr. Ms. Mrs. Miss. Name: _____

Address: _____ Apt: _____ City: _____ State: _____ Zip: _____

Phone: _____ E-mail: _____

Commitment Information:

I/We pledge a total gift of \$ _____ to the St. John's Accessibility Campaign.

I/We wish to contribute this gift as indicated below: *(check one)*

All during 2010 Half during 2010 and half during 2011 One Third each year during 2010, 2011, 2012.

Name(s): _____ Signed: _____

(Please return by Palm Sunday - March 28th, 2010 to St. John's Episcopal Church)

MAKING OUR FUTURE ACCESSIBLE...

Dear Fellow Parishioners,

Improving the accessibility of St. John's facilities, especially to our worship space with easy access to and from the community room and a barrier-free restroom, was identified as the top priority by our congregation during our Vision Process. As a result, a plan was developed, presented to the congregation and confirmed by design professionals as the best and most cost efficient way to address this priority.

We realized the next step was to allow our congregation to decide if we are currently able to fund the project. We embarked on our Accessibility Campaign at our January Annual Meeting. Each member of our Vestry has already made a personal commitment and we would like to encourage you to do the same.

Since the \$150,000 project cost estimate is about **3/4 of the total of our annual pledges**, it can be expected that it will take an average total gift of approximately 3/4 of each household's current pledge amount in order to make our vision a reality. Please prayerfully consider a gift in this range. We understand this may not be possible for everyone and we will continue to encourage those who can make larger gifts to do so. Together, we **can** make this happen!

Thank you for all you do to help St. John's make a difference in the lives of our parishioners and community.

Faithfully,
St. John's Vestry & Accessibility Team

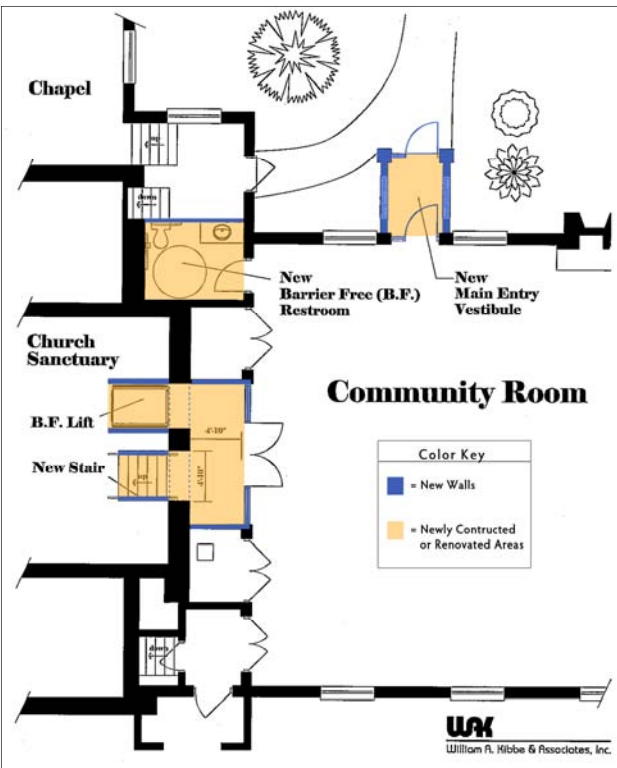

PROJECT FEATURES & BENEFITS:

- ◆ Indoor access between our Worship Space, Community Room, and barrier-free restroom.
- ◆ A larger lift that will carry an Amigo type wheelchair or someone assisting a standard wheelchair.
- ◆ A new inviting "Main Entrance" and "Gathering Space" that will facilitate greeting and community building.
- ◆ Visit www.stjohns-saginaw.org for more photos, videos, benefits, and general information.